

PLAN VIEW

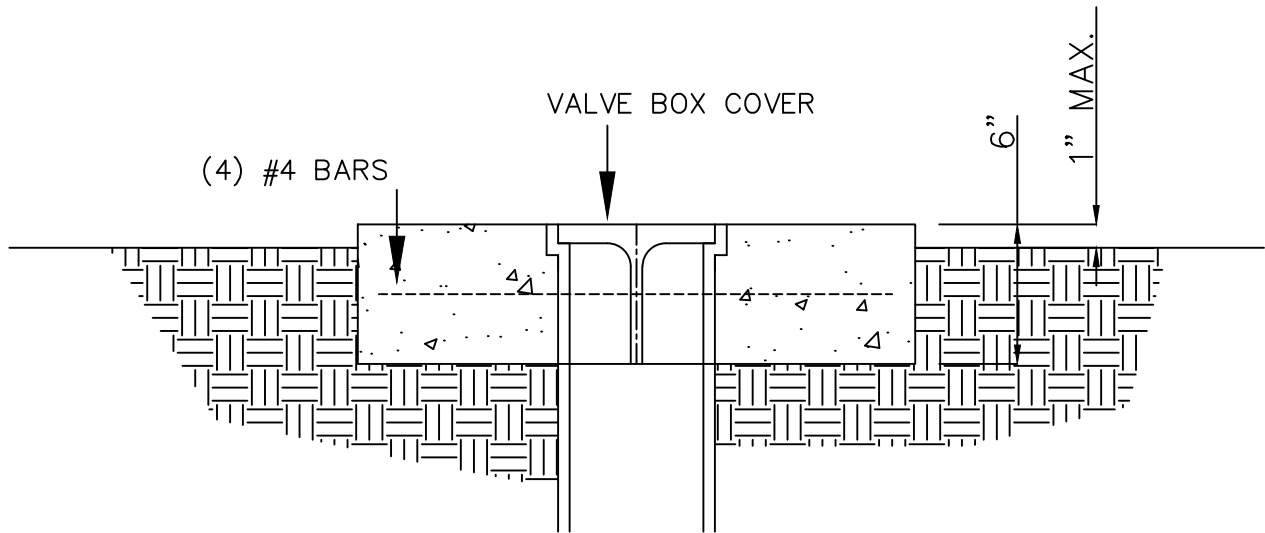

SECTION

- NOTES:  
 1. FOR USE ONLY OUTSIDE  
 PAVED AREAS.  
 2. USE CLASS "A"  
 CONCRETE.

**CITY OF CEDAR PARK**  
 PUBLIC WORKS DEPARTMENT

VALVE BOX PAD

ADOPTED: 10/23/00

SCALE: NTS

INITIAL: ESR